

ONSITE & ONLINE STUDENTS
1ST & 2ND YEAR CERTIFICATES
FULLY ACCREDITED



EQUIPPING SAINTS TO DO THE WORK OF THE MINISTRY

Since 1989

USA | KENYA | NIGERIA | TANZANIA | MOLDOVA | INDIA | VIETNAM

STUDENT CATALOG 2023-2024

"At Faith Landmarks Ministries, we are committed to serve, to reach, and to touch people's lives with the message of the great Gospel of Jesus Christ! FLBI is an extension of this commitment. It is dedicated to training you to be a part of this vision through education and Bible study."

PASTOR RANDY GILBERT
founder/teacher

(804) 729-0002 | www.FLBI.org
info@FLBI.org



PRESIDENTS MESSAGE



PRESIDENT

Pastor Randy Gilbert



VICE PRESIDENT

Pastor Cherie Gilbert

All information, policies, and procedures contained in the 2023-2024 Catalog are current as of the time of this printing. Although every effort has been made to ensure accuracy of the information in this catalog, students and others who use this catalog should consult with the FLBI office for recent additions, deletions, or changes. Updates can also be found online at www.FLBI.org.

Randy Gilbert, with his wife and co-pastor Cherie, founded Faith Landmarks Ministries in Richmond, Virginia in 1980. They are also founders of Faith Landmarks Bible Institute, a two-year program that focuses on ministerial training. They pastor a growing congregation of more than 10,000 people that carries a strong emphasis on fulfilling the Great Commission through helps and equipping the saints to do the work of the ministry.

Pastors Randy and Cherie Gilbert want to welcome everyone to enroll in FLBI. As a student of FLBI, you will receive not only a biblical foundation of who you are in Christ, but also training on how to share your faith to win souls and practical instruction for the day-to-day operations of ministry. Our instructors are all spirit-filled and have been serving the Lord for many years. They have acquired a wealth of knowledge and experience to impart to you and, more importantly, they want to encourage you in your walk with the Lord to love others as He has loved us.

"Love never fails. But where there are prophecies, they will cease; where there are tongues, they will be stilled; where there is knowledge, it will pass away."

1 Corinthians 13:8

TABLE OF CONTENTS

Faith Landmarks Ministries CAMPUS.....	03
FLBI Administration.....	04, 05
General Information.....	05
Beliefs.....	06
FLBI's Accreditation.....	06
FLBI Policies.....	07, 08, 09, 10
2022 – 2023 FLBI Academic Calendar...	11
Programs.....	12
Credit Courses.....	13, 14, 15

BOARD

Pastor Randy Gilbert, President
Pastor Cherie Gilbert, Vice-President
James A. Gilbert, Dean
Leona Anderson, Assistant Dean
Debra D. Johnson, Registrar

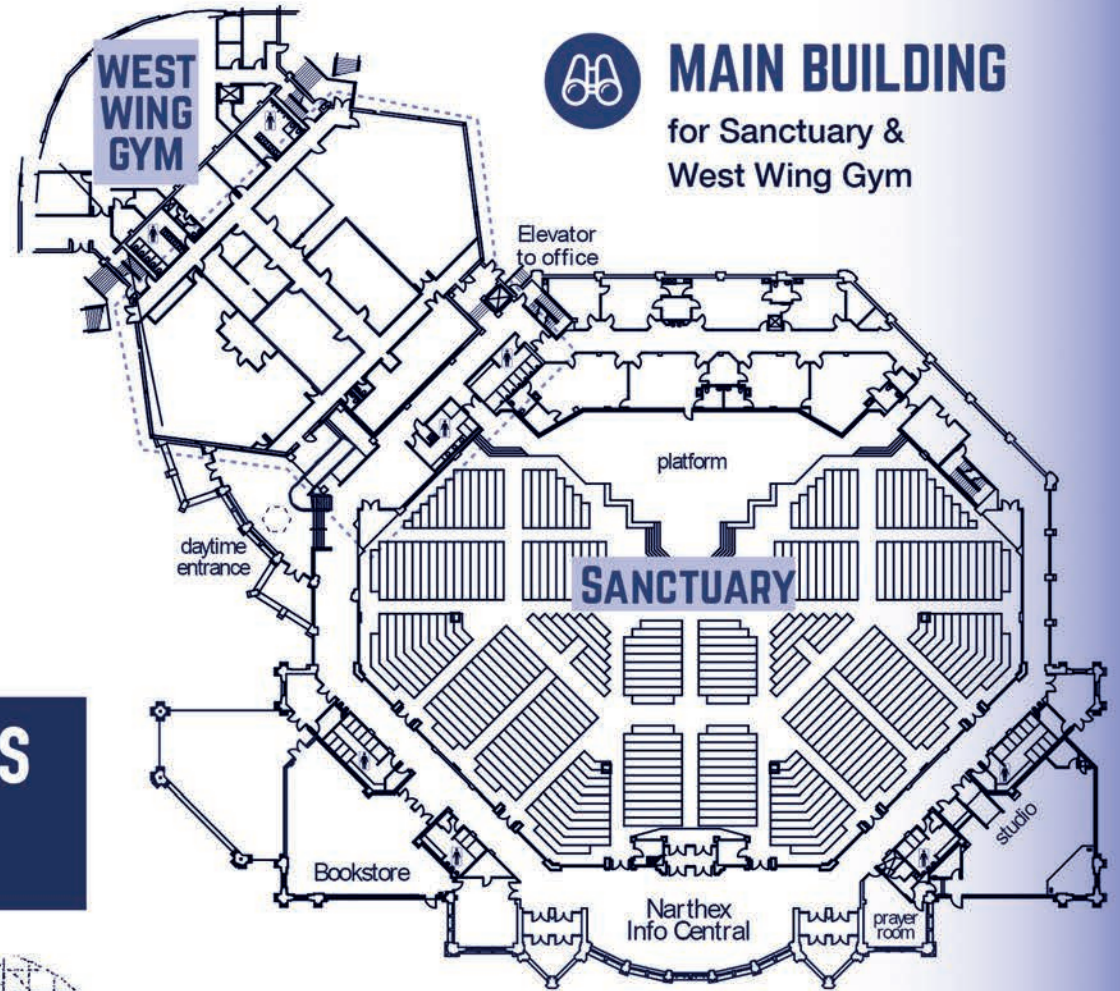

FAITH LANDMARKS MINISTRIES CAMPUS MAP

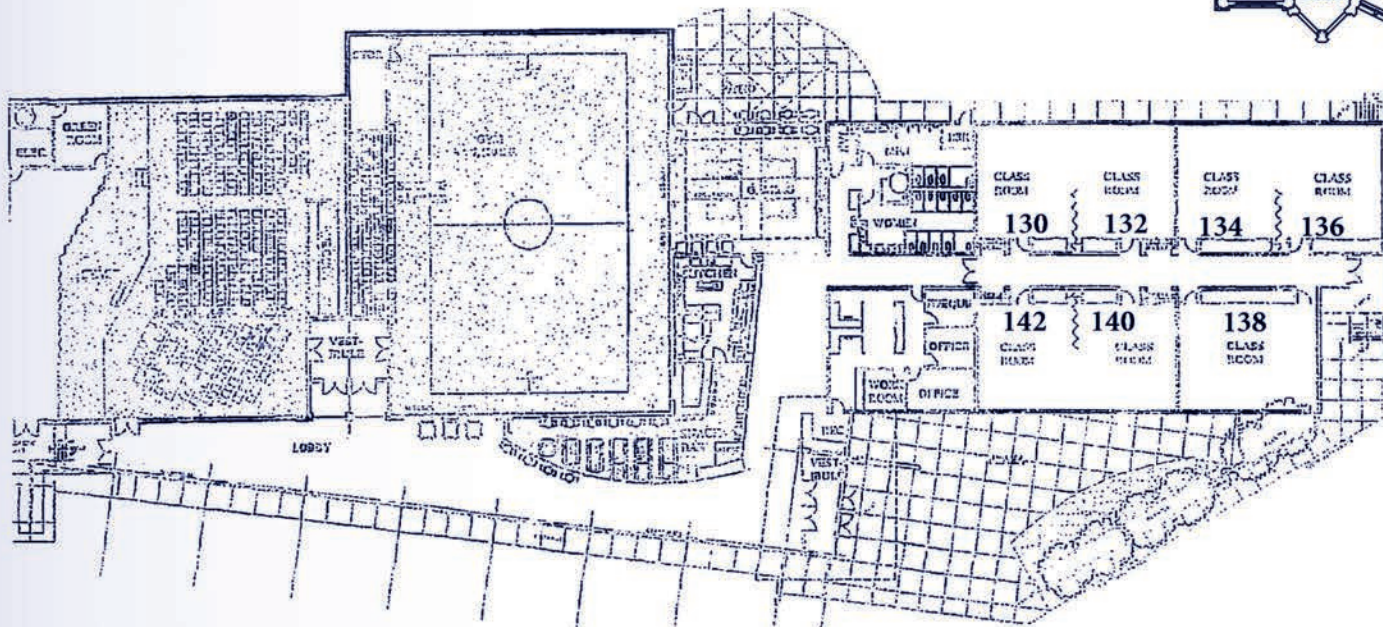

YOUTH BUILDING
for Classrooms
130, 132, 134, 136
138, 140, 142



Pastor Randy Gilbert

Pastor Randy Gilbert was raised in Jacksonville, Florida. He attended Flagler College, and in 1979, he and his wife Cherie graduated from Rhema Bible Training Center. They founded Faith Landmarks Ministries in 1980 and Faith Landmarks Bible Institute in 1989. Pastor Randy is the author of most of the FLBI curriculum.



Pastor Cherie Gilbert

Pastor Cherie Gilbert was raised in Richmond, VA and met Pastor Randy in St. Augustine, FL. They were married in 1976 and graduated from Rhema Bible Training Center in 1979. Pastor Cherie started the first children's ministry at Faith Landmarks Ministries and has served as the Music Director since 1980.



James A. Gilbert

James A. Gilbert was born in St. Augustine, FL, and grew up in Richmond, VA. He has been a member of Faith Landmarks Ministries since its first service on April 6, 1980. James has served as the Media Director/Consultant of Faith Landmarks Ministries since 2001, the Business Manager since 2016, and the Principal of Faith Landmarks Academy since its inception in 2019.



Angela Galante

Angela was born in New York City, but spent most of her school years in Northern Virginia. She attended Radford College (now Radford University), receiving a Bachelor of Science degree. She has been a member of FLM since 1983. After working in the corporate world for almost twenty years, she joined the FLM staff in 1990. She has taught in FLBI since its inception in 1989.



Spencer Person

Spencer Person was born and raised in Richmond, Virginia. He has been a member of Faith Landmarks Ministries since his parents dedicated him as a baby in 1999. Spencer has served in both the "Kidztown" Children's Ministry and the "Solid Rock Youth" Ministry for five years. He has been a staff member of Faith Landmarks and a teacher in Faith Landmarks Academy since 2019.



Mary Jo Ferguson

Mary Jo Ferguson was born in Newport News, Virginia. She graduated cum laude, a Phi Beta Kappa member, from Wells College in Aurora, New York. She received a Bachelor of Arts degree, majoring in American Studies. She also attended the NYU Institute of Fine Arts in New York for 2 years, studying art history for the Museum Curatorship program. She was born again February 21, 1979. In 1983 she became a member of Faith Landmarks Ministries. She was an instructor in Faith Landmarks Bible Institute from its beginning in 1989 until 1993 when she left to join the FLM missionary team in Novgorod, Russia. She has served as a FLM missionary in Novgorod, Russia and in St. Petersburg, Russia for 23 years. While in Russia, she helped open three Bible Schools in Russia and one in Ukraine. She has been an ordained minister with Faith Landmarks Ministries since 1996.



Scott Isbell

Scott was born and raised in Hanover, VA. Following graduation from VCA, he joined the FLM team in Novgorod, Russia to assist with the start of a church and bible school. After a year on the mission field he returned to attend and graduate from Faith Landmarks Bible Institute. He has been an employee of Faith Landmarks Ministries since 1993. He is currently the KidzTown and Outreach Coordinator, Prayer Department and Prison Ministry Team Leader, and serves on the Pastoral Team. He is married and has two adult children. Scott enjoys teaching the Bible locally and internationally.



Nichelle Wright

Nichelle was born in Oklahoma and attended Rhema Bible Training Center where she graduated in 1992. She served as a missionary in Colombia, South America for 2 years teaching in Bible Schools and ministering with evangelistic outreach teams. She also served in Cameroon and Sierra Leone, West Africa for 3 years where she helped plant a Bible School as well as teach and evangelize in rural villages. In 2001, she met and later married her husband, Kevin in Newport News, Virginia. They served in ministry together and assisted in planting 2 churches in Newport News and Williamsburg, Virginia. Nichelle has been a member of Faith Landmarks Ministries since 2016 where she worked on staff for 2 years and now serves as an Instructor.



Garry Taylor

Garry was born in Richmond, Virginia and graduated from Virginia Commonwealth University. He first came to Faith Landmarks Ministries in 1991 to attend Faith Landmarks Bible Institute. Garry and his wife, Debbie, became members of FLM in the spring of 1992. Garry has served in many of the church ministries and outreach events since that time. He graduated from FLBI in 1994 and continues to take new classes that have been offered.

THEOLOGY STUDIES

James A. Gilbert, Dean
Leona Anderson, Assistant Dean
Debra D. Johnson, Registrar

FLBI ADMINISTRATION & FACULTY



Katie Lentz

Originally from North Carolina, she came to Richmond in 1972 working in the Medical Field. Found and joined Faith Landmarks Ministries in 1981 within the first year of the ministry. She is a teacher and department leader of the Children's Ministry as well as a Worship leader on the Worship Team. Katie is a graduate of FLBI, and an Ordained Minister through FLMF. She is on Staff and serves as the primary director and contact for all Pastoral Activity of Faith Landmarks Ministries.



Debbie Taylor

Debbie was born in Richmond, Virginia and was educated at J. Sergeant Reynolds Community College. She is married to her husband, Garry, and they have been members of Faith Landmarks Ministries since 1992. Debbie graduated from FLBI in 1997, and has been an FLBI Instructor since 1999.



Eric Kelly

Eric grew up in Clinton, NY and then attended college at Fairleigh Dickinson University in Teaneck, NJ. He is married to his amazing wife JaJuan, and they have a wonderful daughter, Kyla. His passions in ministry are teaching the Bible, being a prison minister, and evangelizing on the streets.



Angela King

Angela has been a member of Faith Landmarks Ministries since 1997 and joined the FLM staff in 2001. Since joining the church, she has served in a variety of Helps Ministries. She enjoys spending time with her family and serving at FLM. Her desire is that all believers have a revelation of the local church and their place in the Body of Christ.



Karen Lusk

Karen was born in Nebraska where she earned a Bachelor of Science degree in Business Administration from what is now an extension of the University of Nebraska in Kearney. She joined FLM in 1986 after transferring to Richmond from Florida. Karen was part of the first missions team to Novgorod Russia in 1992, graduated 2nd year FLBI in 1996, and 3rd year FLBI in 2017. She has served in many FLM Helps ministries, currently serving in Pastoral Support, Media Presentation, and Zoe Bookstore. Karen has served on the FLMF leadership team as the membership coordinator since 2011. After retiring from a 35-year career in IT, she joined the FLM staff as a project manager in 2018.

GENERAL INFORMATION



MISSION

The most fulfilling life for you, as a Christian, is to walk in the perfect will of God. Our mission is to help you develop a greater understanding and knowledge of the Word of God that provides a strong foundation to stand on and enables you to live that fulfilled life.

VISION

Faith Landmarks Bible Institute (FLBI) was birthed out of a vision God gave Pastors Randy and Cherie Gilbert.

In September 1989, FLBI opened its doors in further fulfillment of that vision. Our purpose is to reach the world for Jesus by equipping the saints to do the work of the ministry.

Together we will fulfill the commission of [Mark 16:15](#), "*Go ye into all the world and preach the gospel to every creature.*"

The school has a three-fold purpose:

- To provide education in the Word of God
- To equip the saints to do the work of the ministry
- To prepare ministers

At Faith Landmarks Ministries, we are committed **to serve, to reach, and to touch** people's lives with the message of the great Gospel of Jesus Christ! FLBI is an extension of this commitment. It is dedicated to training you to be a part of this vision through education and Bible study.

OUR BELIEFS

The Essentials We Believe

- In one God, the maker of all things, and in the Trinity of Father, Son, and Holy Ghost.
- The Son of God, Jesus Christ, became incarnate, was begotten by the Holy Spirit, born of the virgin Mary, and is true God and true man.
- The Bible, in its entirety, to be the inspired Word of God and the only infallible rule of faith and conduct.
- In the resurrection of the dead, the eternal happiness of the saved, and the eternal punishment of the lost.
- In personal salvation of believers through the shed blood of Jesus Christ.
- In the death, burial, and resurrection of Jesus Christ.
- In sanctification by the blood of Christ, in personal holiness of heart and life, and in separation from the world.
- In divine healing and divine health through faith; in the substitutionary sacrifice of Jesus Christ.
- In the baptism of the Holy Ghost accompanied by the initial physical sign of speaking with other tongues as the Spirit of God gives utterance, as distinct from the new birth, and in the nine gifts of the Spirit listed in 1 Corinthians 12.
- In the Christian's hope - the imminent return of the Lord Jesus Christ.
- In intensive world-evangelism and missionary work in accordance with the Great Commission with signs following.

FLBI'S ACCREDITATION



FLBI's accreditation is through The Transworld Accrediting Commission International.

For over 32 years, Transworld Accrediting Commission is an international, non-governmental, educational accrediting body, federally recognized as a non-profit church organization. Transworld has established high standards of excellence and shared Biblical Doctrine. Transworld accredits and assists theological schools, seminaries, universities, colleges, and programs throughout the world on campus, online, and distance learning.

Philosophy

Transworld's philosophy is to demonstrate accountability to the consuming public for education obtained in non-traditional evangelical educational institutions. This accountability is demonstrated by institutions that are accredited by Transworld, having documented evidence of compliance with Transworld standards of structure and governance, material resources, policies, faculty, and curriculum.

Purpose

- To provide a mechanism whereby evangelical educational institutions demonstrate that they meet at least minimal standards of performance.
- To provide consultation services that enable educational institutions to meet accepted standards of performance.
- To provide the consuming public with the current status of institutions which have applied to Transworld for accreditation.
- To provide a centralized information and referral source for issues that concern accredited institutions and non-traditional students.
- To disseminate information about non-traditional educational options to the general public.
- To promote academic excellence and accountability.





Course of Study

The basic course of study at FLBI consists of a two-year program. The first year lays the foundation, with a concentration of the basics of Christian doctrine, plus an overview of the Old and New Testaments. The second year guides the student into a deeper study of the Word of God and the practical aspects of ministry.

A certificate is awarded after successful completion of the fifteen (15) first year courses, and a diploma is awarded when the additional fifteen (15) courses from the second year program are completed successfully.

All awards also require the following two (2) qualifications:

- The student demonstrates Christian character which the school can recommend
- The student has settled all financial liabilities to the school

Students may choose to complete the two-year program using our onsite format, our online format, or our correspondence format.

FLBI Online Format

FLBI is available online! The fees, curriculum, and requirements for course credits and graduation are the same as the onsite school; but now courses may be taken at your own pace as long as the course is completed within 90 days of purchase.

FLBI Correspondence Format (for incarcerated students only)

FLBI is available through a correspondence format. The curriculum and requirements for course credits and graduation are the same as the online and onsite schools, except that there is no time limit for completion.



Entrance Requirements

The desire to serve God and fulfill His commission is the main requirement for entrance into FLBI. While we do not feel that a high school or college diploma is necessary, the course of study will require sincere commitment from the student, as well as reading and writing skills.

Application – An application form must be completed which includes the Christian Standards of Living. The application form must be submitted prior to the registration deadline.

Registration – At least two full weeks will be set aside at the beginning of each trimester for onsite course registration. Registration for onsite courses may be completed online. Registration for online courses is available on demand at flbi.org. Students failing to register during the allotted time will be charged a late fee of \$25.

Tuition and Fees – \$50 per course

Scholarships are available for full and part-time students, veterans, active-duty military, and first responders. Contact the Registrar for details.

Auditing of onsite classes is allowed for graduates. We reserve the right to limit audits based upon space availability.

Transfers - FLBI accepts the transfer of credits from other institutions. Contact the Registrar for details.



GRADING

All students are required to maintain a minimum of 2.0 grade point average in order to qualify for a certificate or a diploma. If a student maintains a 2.0 grade point average, a grade of D will be acceptable for successful completion of a course. A grade of F is not acceptable for the completion of a course for graduation.

The grading system is as follows:

Grade	Percent	Designation	Grade Point
A	93 - 100	Excellent	4
B	85 - 92	Good	3
C	77 - 84	Average	2
D	70 - 76	Poor	1
F	0 - 69	Unacceptable	0
I		Incomplete	*
W		Withdrawal	0

Incomplete Policy

A grade of "Incomplete" is given when a student has not completed all the requirements for the course before it concludes or when a student has not fulfilled the attendance requirements for the course.

Repeating a Course

When a student fails to successfully complete a course required for graduation (due to an "Incomplete", a failing grade, or an overall grade point average less than 2.0), the course must be retaken to graduate. Failing grades will remain on the student's transcript and will affect their final grade point average.

Grading Errors

Students receive report cards at the end of each trimester. It is the student's responsibility to report any grading errors to the registrar's office in a timely manner. If no errors are reported within five weeks following the receipt of the report card, the registrar's office will assume that all records are accurate.

Add/Drop Policy

In order to drop a class, the Registrar must be notified. It is not sufficient to notify the instructor only. Forms for dropping a class are available and must be filled out and submitted to the Registrar prior to withdrawing from the class. Refunds on tuition will only be made on a pro-rated basis for class time not attended up through the fourth week of classes. When adding a class, the student must follow the same procedures as above. However, the completed form must be approved by the Registrar prior to the student's attendance of that class.

Extensions — for onsite school only

It is the responsibility of the student to complete all exams and special assignments within the time specified. If, due to circumstances beyond the student's control, exams or special assignments cannot be completed by the required date, the student may request an extension through the Registrar in writing. All requests will be reviewed by the FLBI administration. However, any request for an extension must be made by the student, in writing, prior to the class in which an exam or special assignment is due. No consideration will be given after the date that the exam or special assignment is due. This could result in failure of such class.

Attendance Policy – for onsite school only

Each course will consist of ten (10) class sessions. We expect students to attend all classes, however, two (2) absences may be allowed in order to still receive a passing grade. Three (3) absences for any particular course may disqualify students from receiving graduation credit for that course. Attendance records will be kept by the Registrar.

Tardiness – for onsite school only

It is our desire that each class begin on time. To that end, a student is considered tardy once the instructor begins teaching the material. Two (2) tardies will be considered an absence. A tardy is also recorded when a student leaves class prior to dismissal by the instructor.

Graduation Policy

To participate in a Graduation Ceremony, first and second year students are required to submit a graduation application by February 1st and to pay all required fees by March 1st. All online courses needed for graduation must be completed by May 1st. Graduation fees are non-refundable. Students who have paid graduation fees but fail final exams will not be allowed to participate in the graduation ceremony.

Classroom Etiquette

ONSITE:

In order to obtain the most desirable atmosphere for receiving instruction, we ask all students to observe the following guidelines:

- No food or drink is allowed in class.
- Neither guests nor children are allowed in class.
- Students should not "chat" with other students during class.
- For questions, please raise your hand and wait for acknowledgement from the instructor.
- Turn off sound and vibration on all cell phones and electronic devices.

ONLINE:

- Students are expected to report any technical issues with online courses to the Registrar in a timely manner.
- All lessons in a course must be viewed in their entirety to receive full credit for the course.
- Fast-forwarding through a lesson, you have not viewed in its entirety, is a violation of the attendance policy and may result in a grade of "incomplete".



(804) 729-0002 | www.FLBI.org
info@FLBI.org



STUDENT RESPONSIBILITIES

We believe that all students of FLBI are **called by God** to be here, and we, the faculty and staff, want to assist in any way that we can. But **YOU**, as a student, also have responsibilities. These few, simple guidelines will help you as you go through the program.

- Spend time everyday reading your Bible and in prayer. The course of study should not replace your personal time with the Lord.
- Attend Orientation.
- Be on time to class, and don't miss any classes if at all possible. This is your anointed time with the Holy Spirit.
- Take good notes in class.
- Pay your tuition bills on time or talk to the registrar.
- Keep files on each class and your grade sheets. This will help you plan your course of study from year to year.
- Review course outlines thoroughly and consistently, during each course session. (2 Timothy 2:15)
- Notify the registrar of changes to your contact information.
- Stay informed of changes that may affect programs and requirements by reading emails and listening to announcements from the Registrar's office.

LICENSURE



Graduation from FLBI with a Certificate or Diploma does not automatically qualify students to teach or to begin a licensed profession. Students interested in teaching should seek licensure through their appropriate state department (In Virginia: Department of Teacher Education and Licensure).

Students interested in a **professional license** should seek licensure through the appropriate state office, circuit court, or county/city licensing agency that handles licensure for that profession.



FALL

FALL REGISTRATION BEGINS
7/30/23

NEW STUDENT ORIENTATION
8/27/23

FALL CLASSES BEGIN
8/27/23

NO CLASS – LABOR DAY BREAK
9/4/23-9/6/23

NO CLASS – CAMPMEETING BREAK
10/10/23-10/16/23

CLASSES RESUME
10/17/23

FALL EXAMS (ALL ONLINE)
11/15/23-11/21/23

FALL BREAK
11/15/23-11/25/23

WINTER

WINTER REGISTRATION
11/5/23

NEW STUDENT ORIENTATION
11/26/23

WINTER CLASSES BEGIN
11/26/23

CHRISTMAS BREAK
12/22/23-1/6/24

CLASSES RESUME
1/7/24

WINTER EXAMS (ALL ONLINE)
2/18/24-2/24/24

WINTER BREAK
2/25/24-3/2/24

SPRING

SPRING REGISTRATION BEGINS
2/11/24

NEW STUDENT ORIENTATION
3/3/24

SPRING CLASSES BEGIN
3/3/24

EASTER BREAK
3/31/24-4/6/24

CLASSES RESUME
4/7/24

**ONLINE COURSE COMPLETION
FOR GRADUATION DEADLINE**
5/1/24

NO CLASS – MOTHER'S DAY
5/12/24

SPRING EXAMS (ALL ONLINE)
5/20/24-5/26/24

GRADUATION DATES

GRADUATION REGISTRATION DEADLINE: 2/1/24

GRADUATION FEE DEADLINE: 3/1/24

GRADUATION: 6/2/24

2023-2024 FLBI ACADEMIC CALENDAR



BASIC BIBLE CERTIFICATE – 1 YEAR

COURSE #	COURSE NAME	CREDIT HOURS
DOCT1101	Blood Covenant	1
DOCT1102	Realities of Redemption	1
DOCT1103	Dynamics of Healing	1
DOCT1104	Righteousness	1
DOCT1105	Faith by Line & Precept	1
DOCT1106	The Ministry of the Holy Spirit	1
DOCT1107	Spiritual Warfare	1
PRAC1101	Following Jesus	1
PRAC1102	New Testament Living	1
PRAC1103	God's Will for Your Financial Life	1
SURV1101	New Testament Survey	1
SURV1102	Eschatology	1
SURV1103	OT Survey: Pentateuch & History	1
SURV1104	OT Survey: Poetry & Prophets	1
SURV1105	Study of Romans	1

ELECTIVES

COURSE #	COURSE NAME	CREDIT HOURS
DOCT1108	The Making of a Champion	1
DOCT2108	Blood Secrets	1

BASIC BIBLE CERTIFICATE – 2 YEAR

COURSE #	COURSE NAME	CREDIT HOURS
DOCT2101	Financial Redemption	1
DOCT2102	Forgiveness & Judgment	1
DOCT2103	Ministry of Christ	1
DOCT2104	The New Man	1
DOCT2105	Servanthood	1
DOCT2106	New Testament Prayer	1
DOCT2107	The Christian Family	1
PRAC2101	Practicalities of the Ministry	1
PRAC2102	Helps Ministry	1
SURV2101	Study of Hebrews	1
THEO2101	Ministry Callings	1
THEO2102	Theology	1
THEO2103	Local Church Ministry	1
THEO2104	Leadership Training	1
THEO2105	Ministerial Training	1



BIBLE DOCTRINE – 1ST YEAR

DOCT1101 - Blood Covenant

Description: To bring a working, biblical knowledge of the Blood Covenant into view for practical application by a believer.

DOCT1102 - Realities of Redemption

Description: Covers vital specifics of redemption, which is important to all believers.

DOCT1103 - Dynamics of Healing

Description: To lay the scriptural foundation for healing available to New Testament believers; to teach the use of faith as the means of walking in divine health.

DOCT1104 - Righteousness

Description: To lay the scriptural foundation of man's need for righteousness, and God's means of providing righteousness for man.

DOCT1105 - Faith by Line & Precept

Description: This course will provide the student with a complete study of faith, from both the Old and New Testaments, so that one can gain an understanding of the significance of living by faith as a Christian and as a minister of the Gospel.

DOCT1106 - The Ministry of the Holy Spirit

Description: The purpose of this course is to teach the student about the mission and the operation of the Holy Spirit in the earth and to the Church.

DOCT1107 - Spiritual Warfare

Description: Instructs and guides a believer in spiritual warfare from a novice position, all the way to "comfortable veteran."

DOCT1108 - The Making of a Champion

Description: We tend to view champions as legends and heroes, but humanity falls short of God's expectations. In this course, learn how God's expectations were met through Jesus and how we can follow Jesus' pattern.

BIBLE DOCTRINE – 2ND YEAR

DOCT2101 - Financial Redemption

Description: Biblical foundation for deliverance from Poverty. Keys to living in Abundance.

DOCT2102 - Forgiveness & Judgment

Description: To teach the student about God's divine mercy and forgiveness through the saving grace of the Lord Jesus Christ.

DOCT2103 - Ministry of Christ

Description: Using Biblical topics to detail the Ministry of Jesus Christ in all aspects.

DOCT2104 - The New Man

Description: To provide a scriptural base, in a teaching format, for the Pauline Revelation, instruct in the practicality of "walking in the New Man", and illustrate from the New Testament "what God hath wrought in Christ."

DOCT2105 - Servanthood

Description: To obtain a Biblical understanding of servanthood, and to learn the difference between slavery and service.

DOCT2106 - New Testament Prayer

Description: To instill a biblically based, New Testament basis, for successful prayer life.

DOCT2107 - The Christian Family

Description: To teach the student about God's plan for the family. It emphasizes the significance of submitting the whole family to the Word.

DOCT2108 - Blood Secrets

Description: To present an accurate doctrinal exposé of the biblical truth concerning Blood.

BIBLE PRACTICUM - 1ST YEAR

PRAC1101 - Following Jesus

Description: To lay a biblical foundation for the student, and all believers, to make right choices.

PRAC1102 - New Testament Living

Description: To instill biblical truths and practical implementation on lifestyle for believers.

PRAC1103 - God's Will for Your Financial Life

Description: To lay a scriptural foundation for a believer's life.

BIBLE PRACTICUM - 2ND YEAR

PRAC2101 - Practicalities of the Ministry

Description: To impart a general scriptural understanding of the practical and natural side of the ministry of the Lord Jesus Christ.

PRAC2102 - Helps Ministry

Description: To fully develop a scriptural understanding of Helps Ministry.

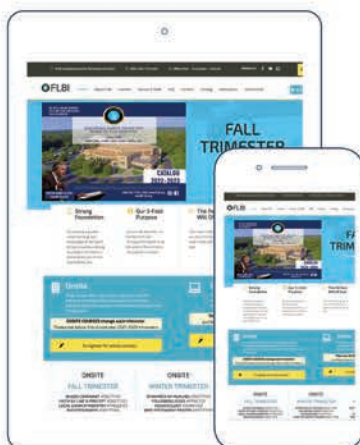

*Scan the QR
code to
learn more!*



FLBI is worldwide



ONSITE



ONLINE



Faith Landmarks Ministries
8491 Chamberlayne Rd
(804) 729-0002 | www.FLBI.org
info@FLBI.org





BIBLE SURVEY – 1ST YEAR

SURV1101 - New Testament Survey

Description: A concise overview of each book of the New Testament; designed to expand the student's concept of the complete work that Jesus began here on the earth.

SURV1102 - Eschatology

Description: To teach the scriptural truth of the end times, emphasizing the time of the Rapture of the church through the establishment of the New Jerusalem. The course includes both doctrinal and chronological elements, as presented in the Bible.

SURV1103 - Old Testament Survey – Pentateuch & History

Description: This is a survey course designed to present an overview of each Old Testament book from Genesis through Esther, and how they relate to each other and how they relate to you as a Christian.

SURV1104 - Old Testament Survey – Poetry & Prophets

Description: This is a survey course designed to present an overview of each Old Testament book from Job through Malachi, how they relate to each other, and how they relate to you as a Christian.

SURV1105 - Study of Romans

Description: To instill an appreciation for great Bible truth. (It is said in literary circles that the Book of Romans ranks at the top of works done by man. We know it to be given by Inspiration of the Holy Ghost.)

BIBLE SURVEY – 2ND YEAR

SURV2101 - Study of Hebrews

Description: To equip the students of this course with the Book of Hebrews, giving them a "working knowledge" of the biblical truths laid out in Hebrews.

BIBLE THEOLOGY – 2ND YEAR

THEO2101 - Ministry Callings

Description: To instill the Biblical basis for God's building of the Church.

THEO2102 - Theology

Description: This course provides a systematic approach to the theology of the Bible to be used as a guide for the lifelong journey of "rightly dividing the Word of God". (2 Timothy 2:15)

THEO2103 - Local Church Ministry

Description: To establish a biblical perspective of the birth, structure, and operation of the local church and to replace traditional opinion with Bible truth in the life of the local church.

THEO2104 - Leadership Training

Description: To lay a biblical foundation for leadership.

THEO2105 - Ministerial Training

Description: To lay a biblical foundation of ministerial training for believers intent on fulfilling their calling in the Body of Christ.



Visit us online to learn more about FLBI.

info@FLBI.org | www.FLBI.org | 804-729-0002



NIGERIA



NIGERIA



VIETNAM

FAITH LANDMARKS MINISTRIES
8491 CHAMBERLAYNE RD | RICHMOND, VA 23227, USA

